

Installation Precautions:

1. Please read the manual carefully before installation;
2. This lamp is used in the W three-phase track system or used in other companies' compatible tracks, with rail parameters: Input voltage: AC 220-240V Maximum current: 16A Maximum load: 3680W;
3. Installed by a qualified electrician;
4. In order to avoid the risk of electric shock, please confirm to turn off the power before installing and maintaining the lamps;
5. Only suitable for indoor installation and use (not for use in humid environment);
6. The light source of this lamp is irreplaceable, once it needs to be replaced (such as the end of the life of the light source), the entire lamp should be replaced;
7. Keep this manual in a safe place in case you need it.

Note: In order to prevent electric shock and avoid damage to the lamp, please turn off the power before installing, maintaining, and replacing accessories, and install with electricity is not allowed.

I.Assemble the rail light connector

1. Ensure that the "locking handle" and "conductive switch" are at a 90-degree angle to the connector before assembly, and the commutation handle is in "1", "2", and "3" gears.

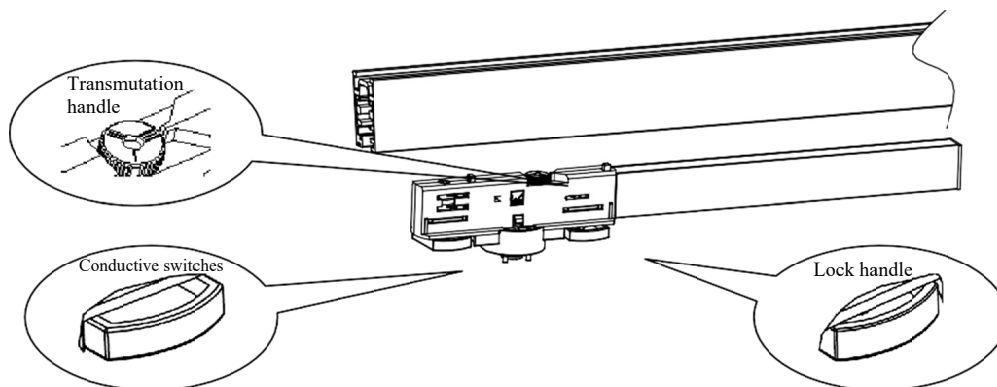

2. Align the boss of the rail light connector with the groove of the rail before assembly.

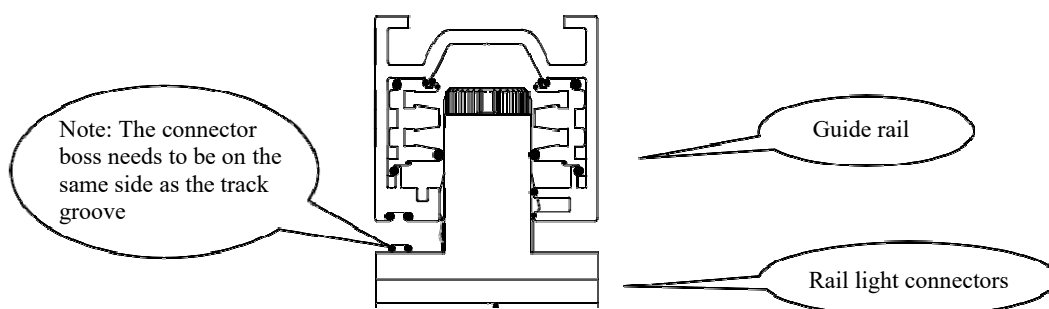

3. After assembly, turn the "conductive switch" clockwise and the "locking handle" 90 degrees counterclockwise to turn on and lock.

Authorized by WAC Lighting Corporation, USA, holder of the "WAC" trademark.

China Marketing Headquarters: WAC Lighting Technology (Shanghai) Co.

Address: Room 102, No. 14, Lane 299, Bisheng Road, Pilot Free Trade Zone, Shanghai (201204), P.R.C. Manufactured

China Factory: WAC Lighting(Dongguan)Co,Ltd

Address: No. 390, Qingfeng Road, Qingxi Town, Dongguan City, Guangdong Province, 523653, P.R. China

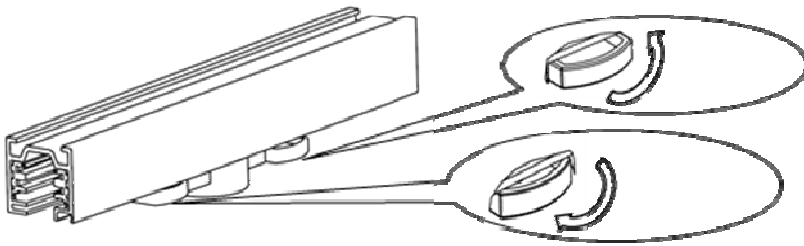

Note: Removing the rail light connector is the opposite procedure for installing the rail light connector.

II. Luminaire Adjustment:

1. After the lamp is installed, the lamp body can be rotated vertically by 90° and horizontally by 365° .

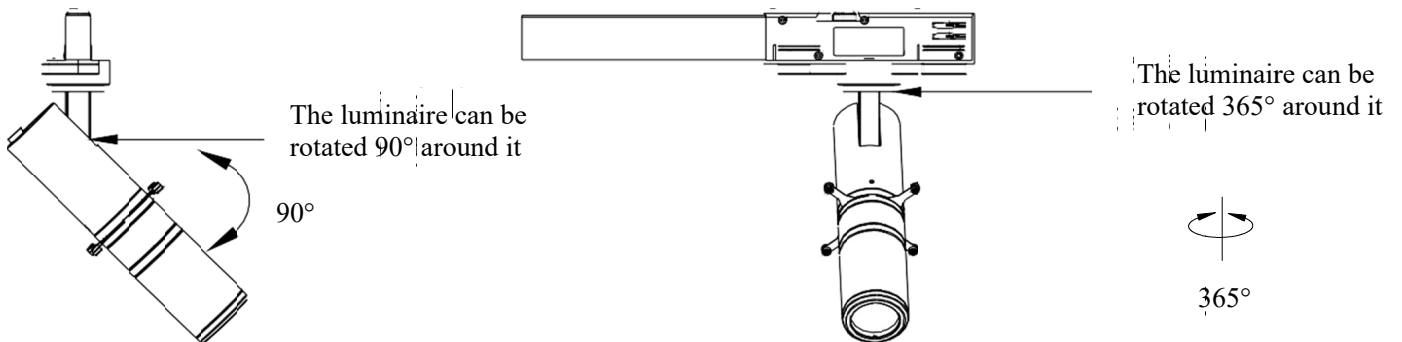

2. Knob dimming instructions:

Turn the dimming knob clockwise by hand as shown to make 10%-100% dimming (see figure below).

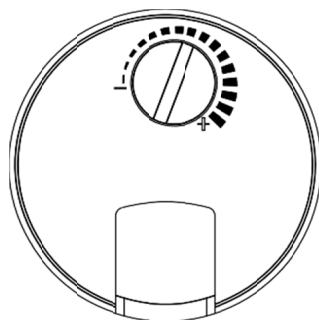

3. Spot shape adjustment of lamps: Adjusting the four light blocking plates on the lamps can adjust the shape of the light output into the required square, diamond or trapezoid, etc.; A circular spot is obtained when the light barrier is pulled to the outermost point.

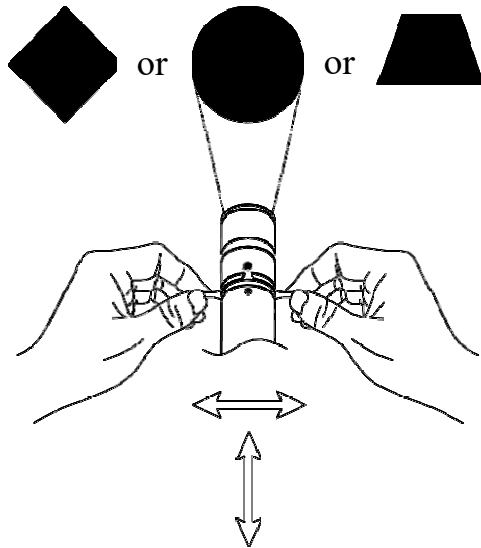

4. Angle adjustment of lamps (angle range: 15°-36°): Rotate two different rotation circles to adjust the forward and backward movement of the lens group in the lamp, and adjust the illumination angle and clarity of the lamp.

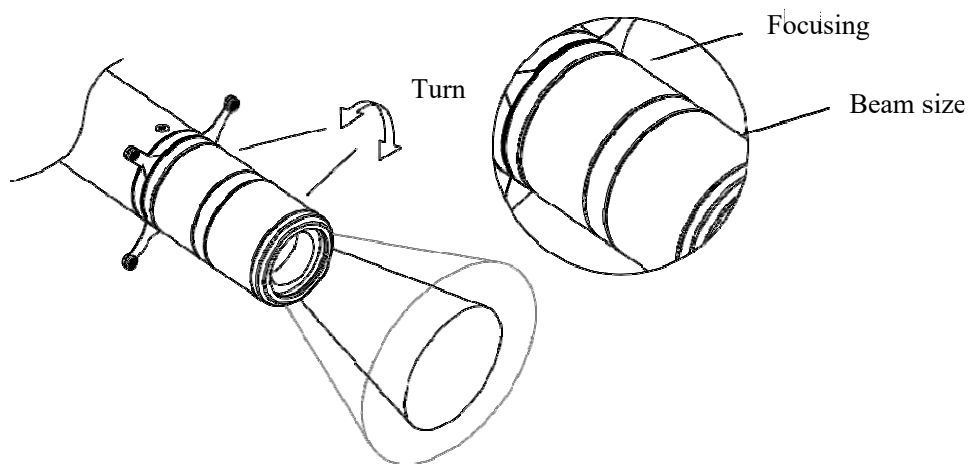

Authorized by WAC Lighting Corporation, USA, holder of the "WAC" trademark.

China Marketing Headquarters: WAC Lighting Technology (Shanghai) Co.

Address: Room 102, No. 14, Lane 299, Bisheng Road, Pilot Free Trade Zone, Shanghai (201204), P.R.C. Manufactured

China Factory: WAC Lighting(Dongguan)Co,Ltd

Address: No. 390, Qingfeng Road, Qingxi Town, Dongguan City, Guangdong Province, 523653, P.R. China

III. Replace the lens assembly or lens

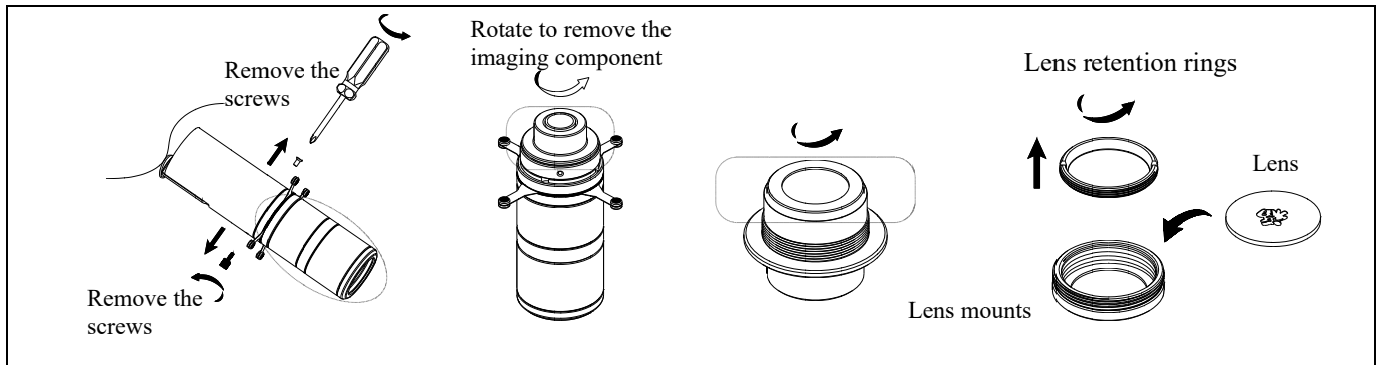

V. Maximum lifting weight:

1. The maximum weight that the rail system is capable of withstanding is shown in the diagram below, which includes the weight of the entire rigging system.
2. A single adapter can withstand a maximum load of 10 kg (load is applied to the adapter according to the normal installation position of the luminaire).

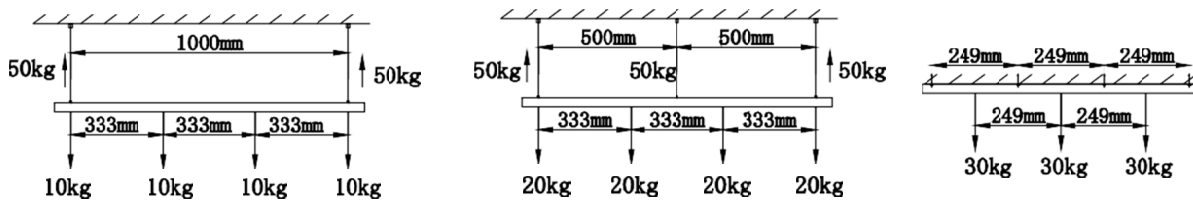

Authorized by WAC Lighting Corporation, USA, holder of the "WAC" trademark.

China Marketing Headquarters: WAC Lighting Technology (Shanghai) Co.

Address: Room 102, No. 14, Lane 299, Bisheng Road, Pilot Free Trade Zone, Shanghai (201204), P.R.C. Manufactured

China Factory: WAC Lighting(Dongguan)Co.,Ltd

Address: No. 390, Qingfeng Road, Qingxi Town, Dongguan City, Guangdong Province, 523653, P.R. China

Installation Precautions:

1. Please read the manual carefully before installation;
2. This lamp is used in the W2 three-phase track system or used in other companies' compatible tracks, with rail parameters: Input voltage: AC 220-240V Maximum current: 16A Maximum load: 3680W;
3. Installed by a qualified electrician;
4. In order to avoid the risk of electric shock, please confirm to turn off the power before installing and maintaining the lamps;
5. Only suitable for indoor installation and use (not for use in humid environment);
6. The light source of this lamp is irreplaceable, once it needs to be replaced (such as the end of the life of the light source), the entire lamp should be replaced;
7. Keep this manual in a safe place in case you need it.

I. Assemble the rail light connector

1. Ensure that the "conductive switch" is parallel to the connector before assembly, and display the "1" or "2" or "3" position status in the circle of the commutation knob as required.

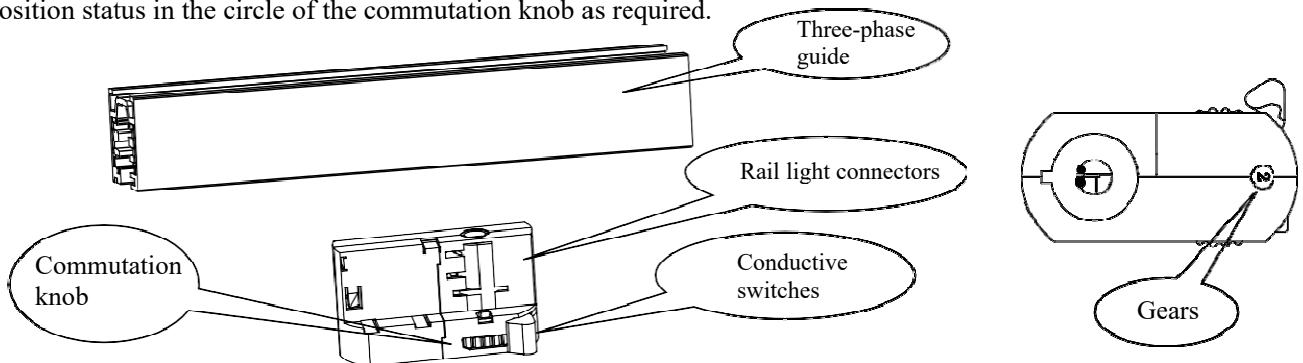

2. Align the boss of the rail light connector with the groove of the rail before assembly.

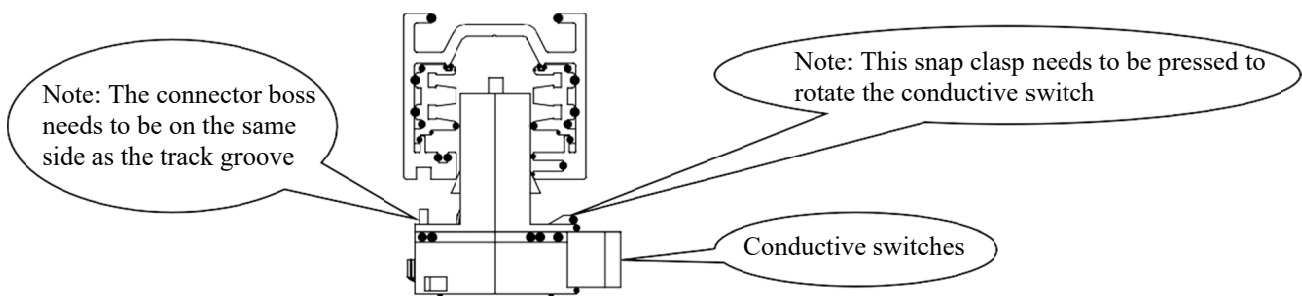

3. After the assembly is completed, the "conductive switch" is rotated 90 degrees clockwise to turn on.

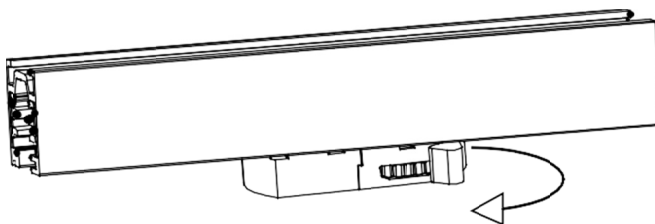

Note: Removing the rail light connector is the opposite procedure for installing the rail light connector.

Authorized by WAC Lighting Corporation, USA, holder of the "WAC" trademark.

China Marketing Headquarters: WAC Lighting Technology (Shanghai) Co.

Address: Room 102, No. 14, Lane 299, Bisheng Road, Pilot Free Trade Zone, Shanghai (201204), P.R.C. Manufactured

China Factory: WAC Lighting(Dongguan)Co,Ltd

Address: No. 390, Qingfeng Road, Qingxi Town, Dongguan City, Guangdong Province, 523653, P.R. China

II. Luminaire Adjustment:

1. After the lamp is installed, the lamp body can be rotated vertically by 90° and horizontally by 355°.

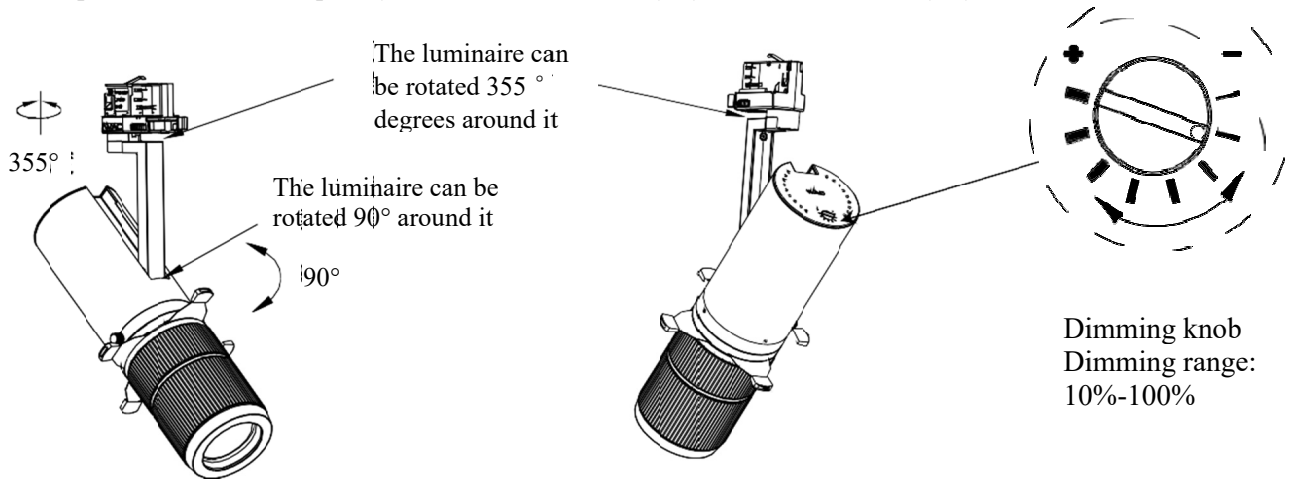

2. Spot shape adjustment of lamps: Adjust the four light stoppers on the lamps to adjust the shape of the light into the required square, diamond or trapezoid, etc.; A circular spot is obtained when the light barrier is pulled to the outermost point.

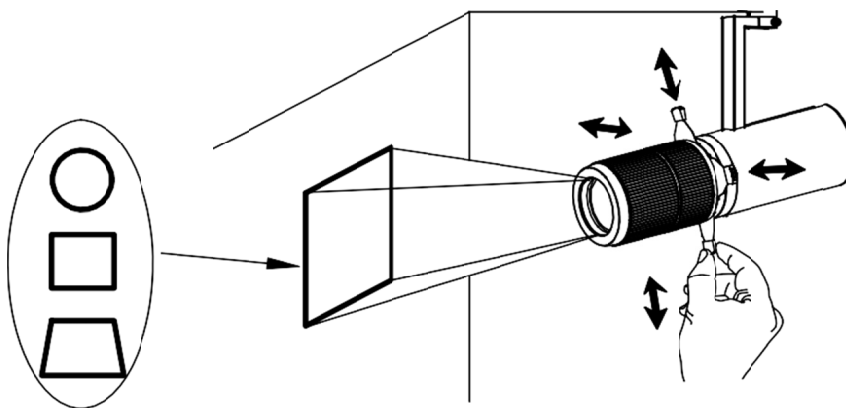

3. Lamp angle adjustment (angle range: 24°-40°): Rotate the rotation circle A/B to adjust the forward and backward movement of the lens group in the lamp, and adjust the illumination angle and clarity of the lamp.

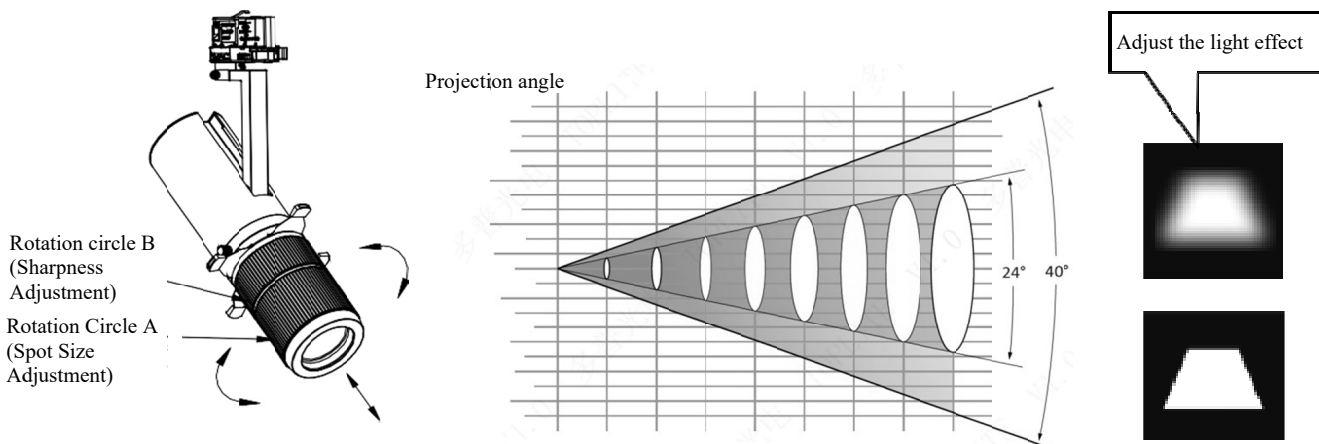

Authorized by WAC Lighting Corporation, USA, holder of the "WAC" trademark.

China Marketing Headquarters: WAC Lighting Technology (Shanghai) Co.

Address: Room 102, No. 14, Lane 299, Bisheng Road, Pilot Free Trade Zone, Shanghai (201204), P.R.C. Manufactured

China Factory: WAC Lighting(Dongguan)Co,Ltd

Address: No. 390, Qingfeng Road, Qingxi Town, Dongguan City, Guangdong Province, 523653, P.R. China

4. Spot direction adjustment:

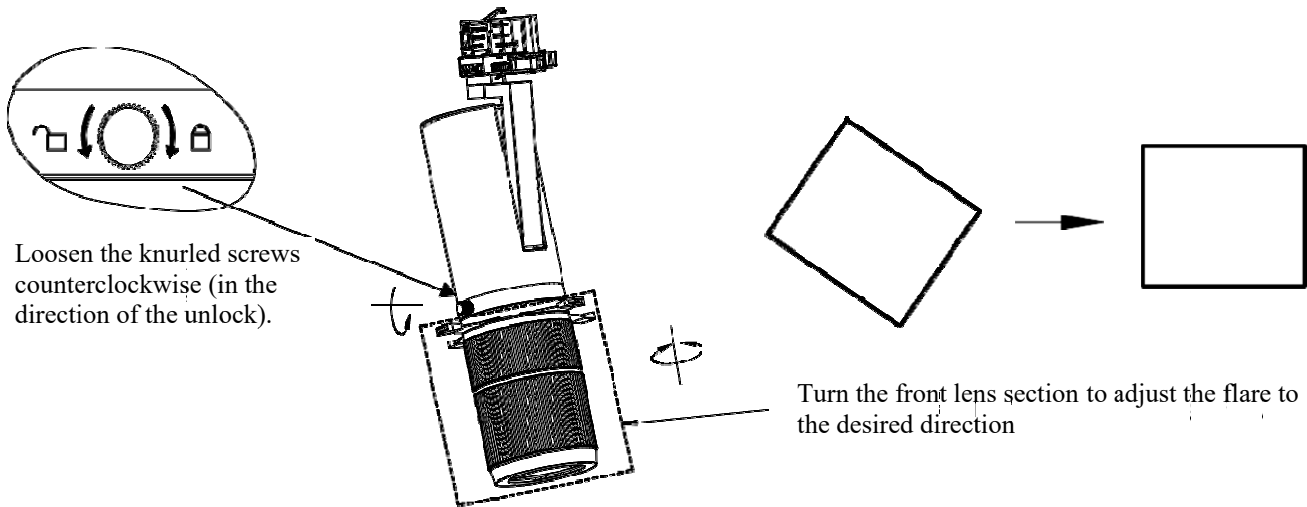

II. Installation of accessories (installation of GOBO glass sheets):

Insert the GOBO glass sheet as follows, and rotate and adjust the "Rotation Circle A" / "Rotation Circle B" and the light barrier to obtain a pattern that satisfies the image size and definition.

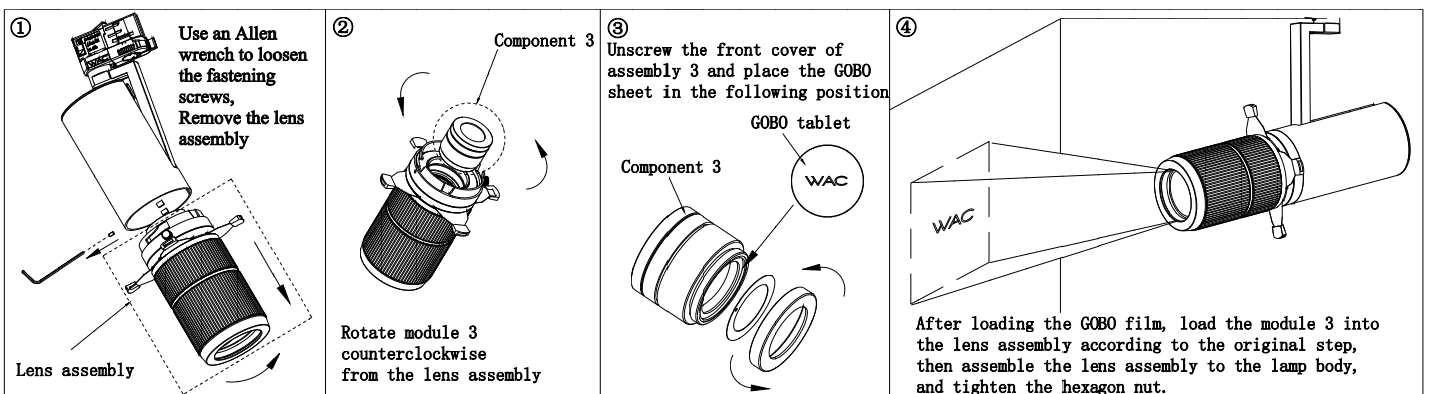

IV. Maximum lifting weight:

- The maximum weight that the rail system can bear is shown in the figure below, which includes the weight of the entire rigging system.
- A single adapter can withstand a maximum load of 10kg (the load is applied to the adapter according to the normal installation position of the luminaire).

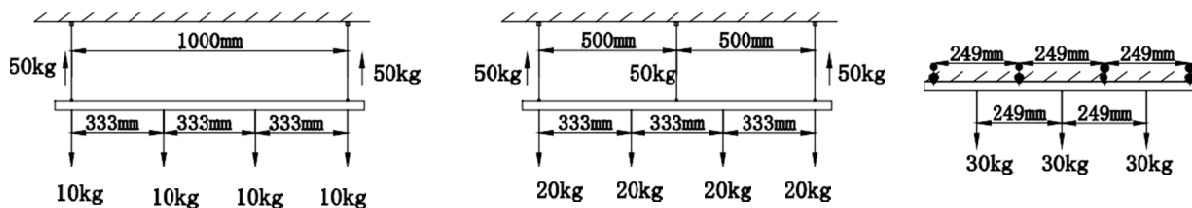

Authorized by WAC Lighting Corporation, USA, holder of the "WAC" trademark.

China Marketing Headquarters: WAC Lighting Technology (Shanghai) Co.

Address: Room 102, No. 14, Lane 299, Bisheng Road, Pilot Free Trade Zone, Shanghai (201204), P.R.C. Manufactured

China Factory: WAC Lighting(Dongguan)Co,Ltd

Address: No. 390, Qingfeng Road, Qingxi Town, Dongguan City, Guangdong Province, 523653, P.R. China

Installation Precautions:

1. Please read the manual carefully before installation;
2. This lamp is used in the W2 three-phase track system or used in other companies' compatible tracks, with rail parameters: Input voltage: AC 220-240V Maximum current: 16A Maximum load: 3680W;
3. Installed by a qualified electrician;
4. In order to avoid the risk of electric shock, please confirm to turn off the power before installing and maintaining the lamps;
5. Only suitable for indoor installation and use (not for use in humid environment);
6. The light source of this lamp is irreplaceable, once it needs to be replaced (such as the end of the life of the light source), the entire lamp should be replaced;
7. Keep this manual in a safe place in case you need it.

I. Assemble the rail light connector

1. Ensure that the "conductive switch" is parallel to the connector before assembly, and display the "1" or "2" or "3" position status in the circle of the commutation knob as required.

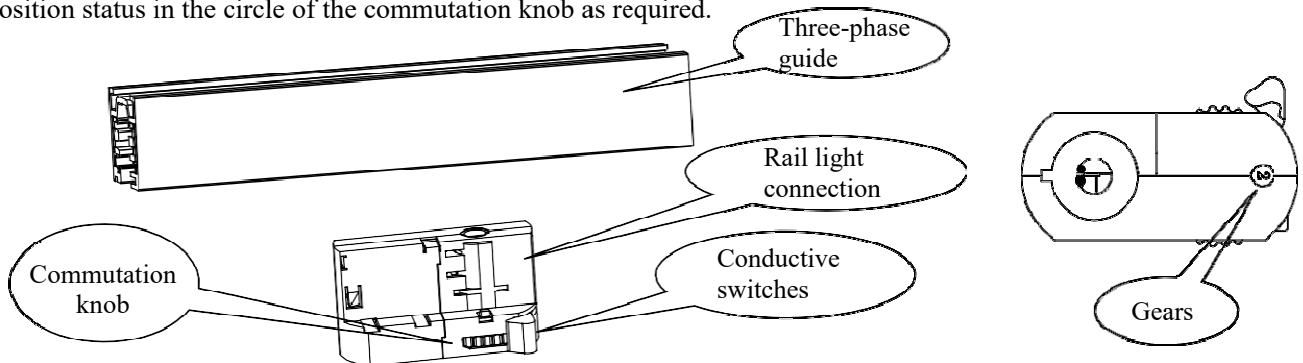

2. Align the boss of the rail light connector with the groove of the rail before assembly.

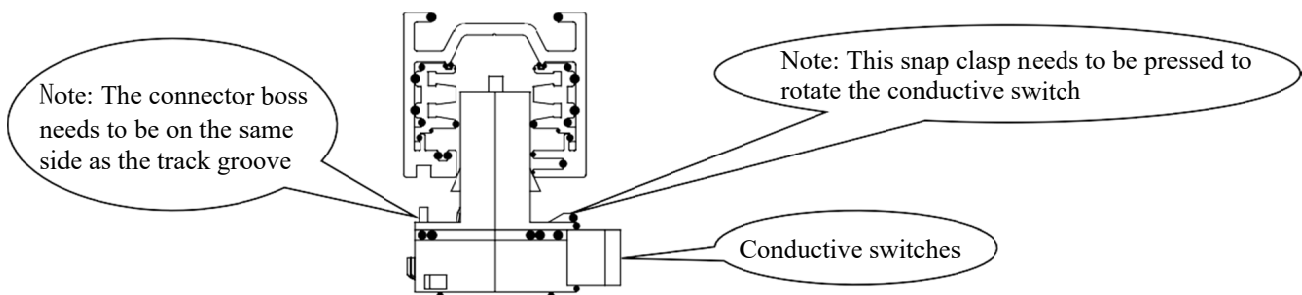

3. After the assembly is completed, the "conductive switch" is rotated 90 degrees clockwise to turn on.

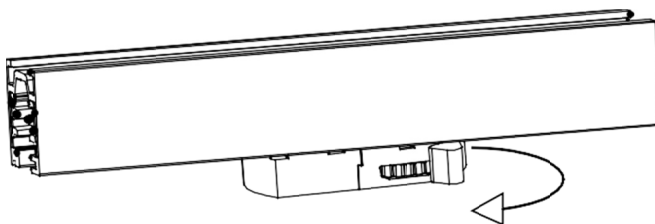

Note: Removing the rail light connector is the opposite procedure for installing the rail light connector.

Authorized by WAC Lighting Corporation, USA, holder of the "WAC" trademark.

China Marketing Headquarters: WAC Lighting Technology (Shanghai) Co.

Address: Room 102, No. 14, Lane 299, Bisheng Road, Pilot Free Trade Zone, Shanghai (201204), P.R.C. Manufactured

China Factory: WAC Lighting(Dongguan)Co,Ltd

Address: No. 390, Qingfeng Road, Qingxi Town, Dongguan City, Guangdong Province, 523653, P.R. China

II. Luminaire Adjustment:

1. After the lamp is installed, the lamp body can be rotated vertically by 90° and horizontally by 355°.

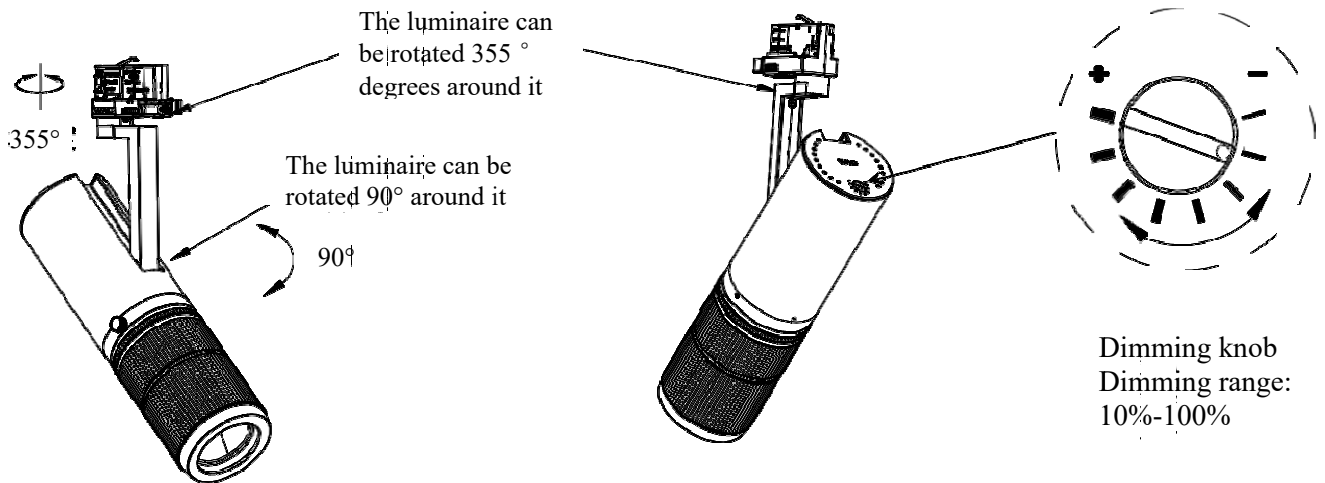

2. Adjust the shape of the light spot of the lamp: rotate and adjust the rotation circle C on the lamp to adjust the size of the light spot to obtain a circular spot of different sizes;

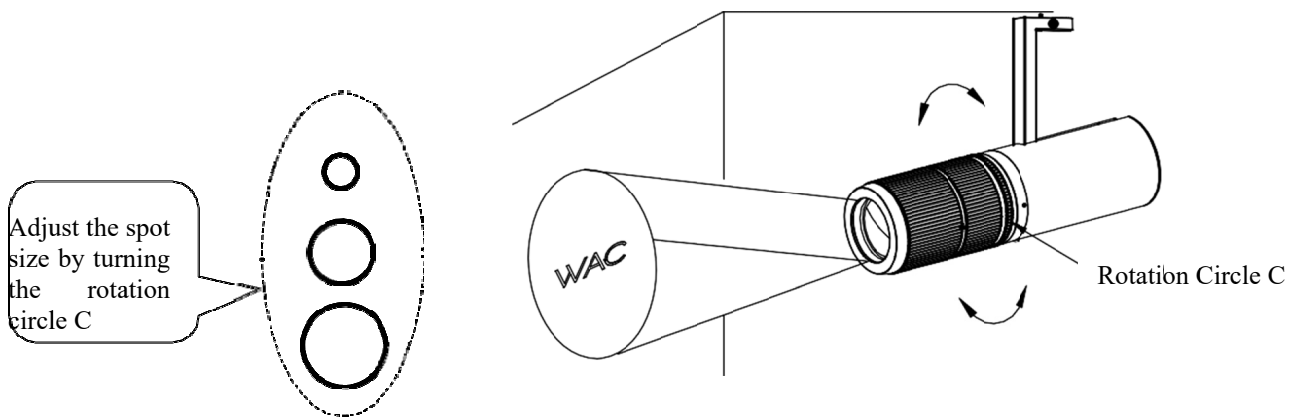

3. Angle adjustment of lamps (angle range: 24°-40°): Rotate the rotation circle A/B to adjust the forward and backward movement of the lens group in the lamp, and adjust the illumination angle and clarity of the lamp.

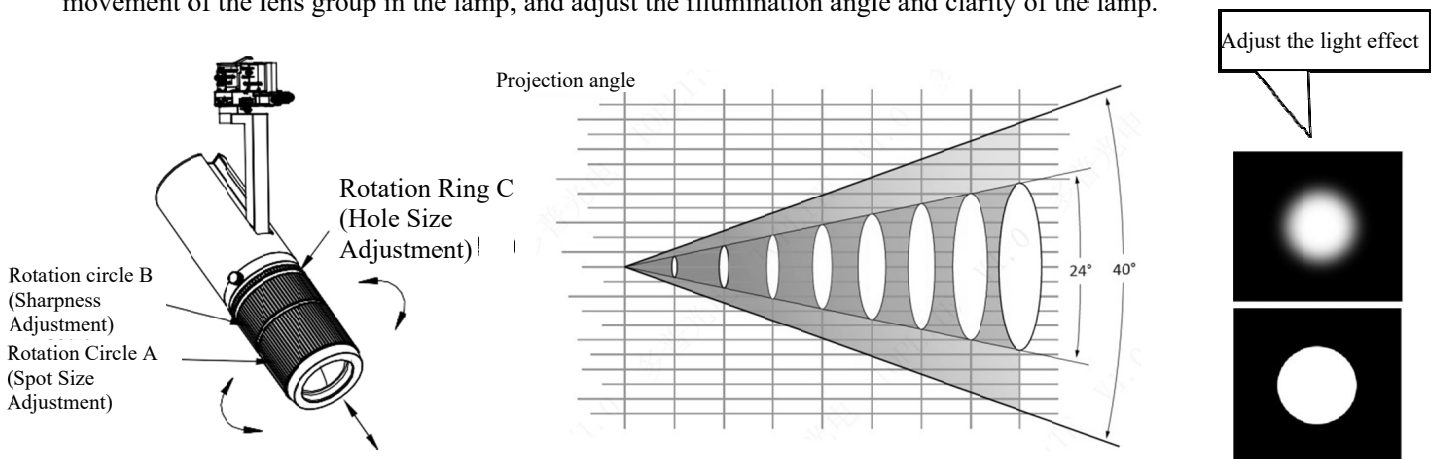

Authorized by WAC Lighting Corporation, USA, holder of the "WAC" trademark.

China Marketing Headquarters: WAC Lighting Technology (Shanghai) Co.

Address: Room 102, No. 14, Lane 299, Bisheng Road, Pilot Free Trade Zone, Shanghai (201204), P.R.C. Manufactured

China Factory: WAC Lighting(Dongguan)Co,Ltd

Address: No. 390, Qingfeng Road, Qingxi Town, Dongguan City, Guangdong Province, 523653, P.R. China

4. Spot Direction Adjustment:

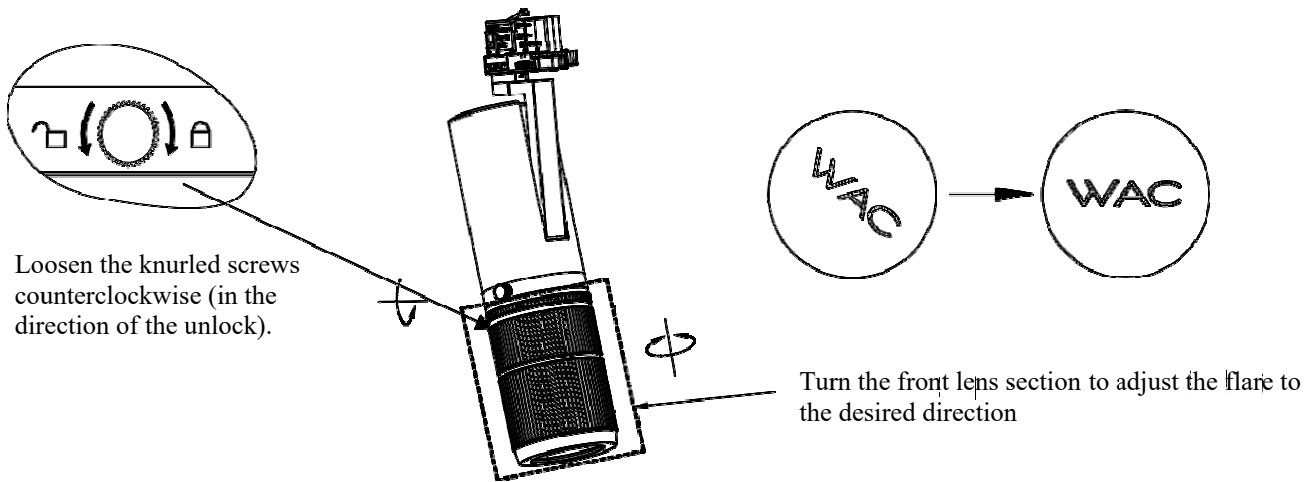

III. Installation of accessories (installation of GOBO glass sheets):

Insert the GOBO glass sheet as follows, and rotate and adjust the "Rotation Circle A" / "Rotation Circle B" and the light barrier to obtain a pattern that satisfies the image size and definition.

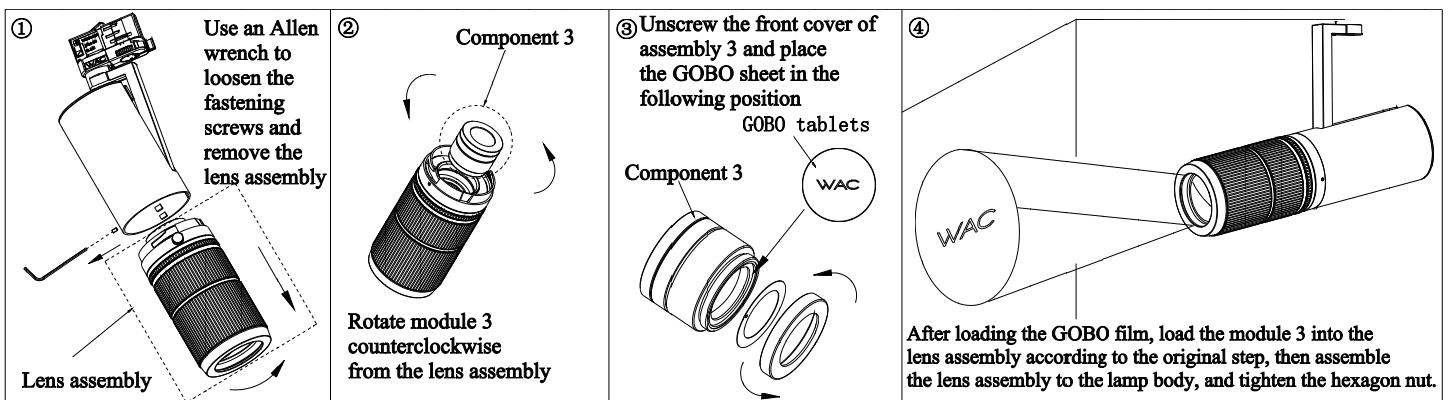

IV. Maximum lifting weight:

- The maximum weight that the rail system can bear is shown in the figure below, which includes the weight of the entire rigging system.
- A single adapter can withstand a maximum load of 10kg (the load is applied to the adapter according to the normal installation position of the luminaire).

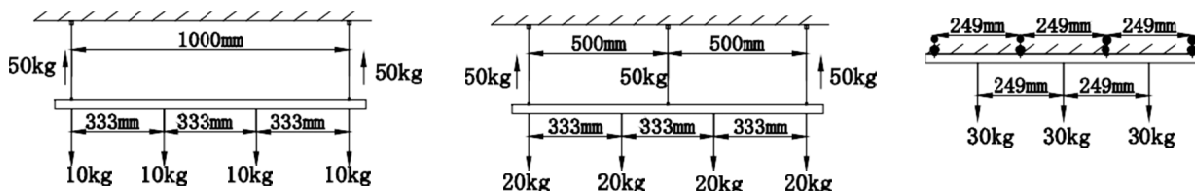

Authorized by WAC Lighting Corporation, USA, holder of the "WAC" trademark.

China Marketing Headquarters: WAC Lighting Technology (Shanghai) Co.

Address: Room 102, No. 14, Lane 299, Bisheng Road, Pilot Free Trade Zone, Shanghai (201204), P.R.C. Manufactured

China Factory: WAC Lighting(Dongguan)Co.,Ltd

Address: No. 390, Qingfeng Road, Qingxi Town, Dongguan City, Guangdong Province, 523653, P.R. China