

Installation Precaution

1. Please read the instructions carefully before installation;
2. Please have it installed by a professional electrician;
3. To avoid the risk of electric shock, please make sure the power is off before installation and maintenance;
4. Please allow enough space for the fixture to be embedded in the ceiling surface. Do not cover insulation and combustible materials above the luminaires to prevent causing a fire;
5. Strictly prohibit touching the surface of the reflector of the luminaires while it is energized, in order to avoid high temperature burns;
6. Please do not install the luminaire on unstable skylight to avoid falling of the luminaire;
7. Please keep the instruction manual for future reference;
8. Alternative light sources in this luminaire should be replaced by the manufacturer or its service agent or a qualified technician.

Fixture Installation & Wiring:

Model	X Max	Y	Z	D(Hole Dimensions)	H (Ceiling Thickness)
ADWT41*	2m	≤X	≤3X	100mm	1~20mm

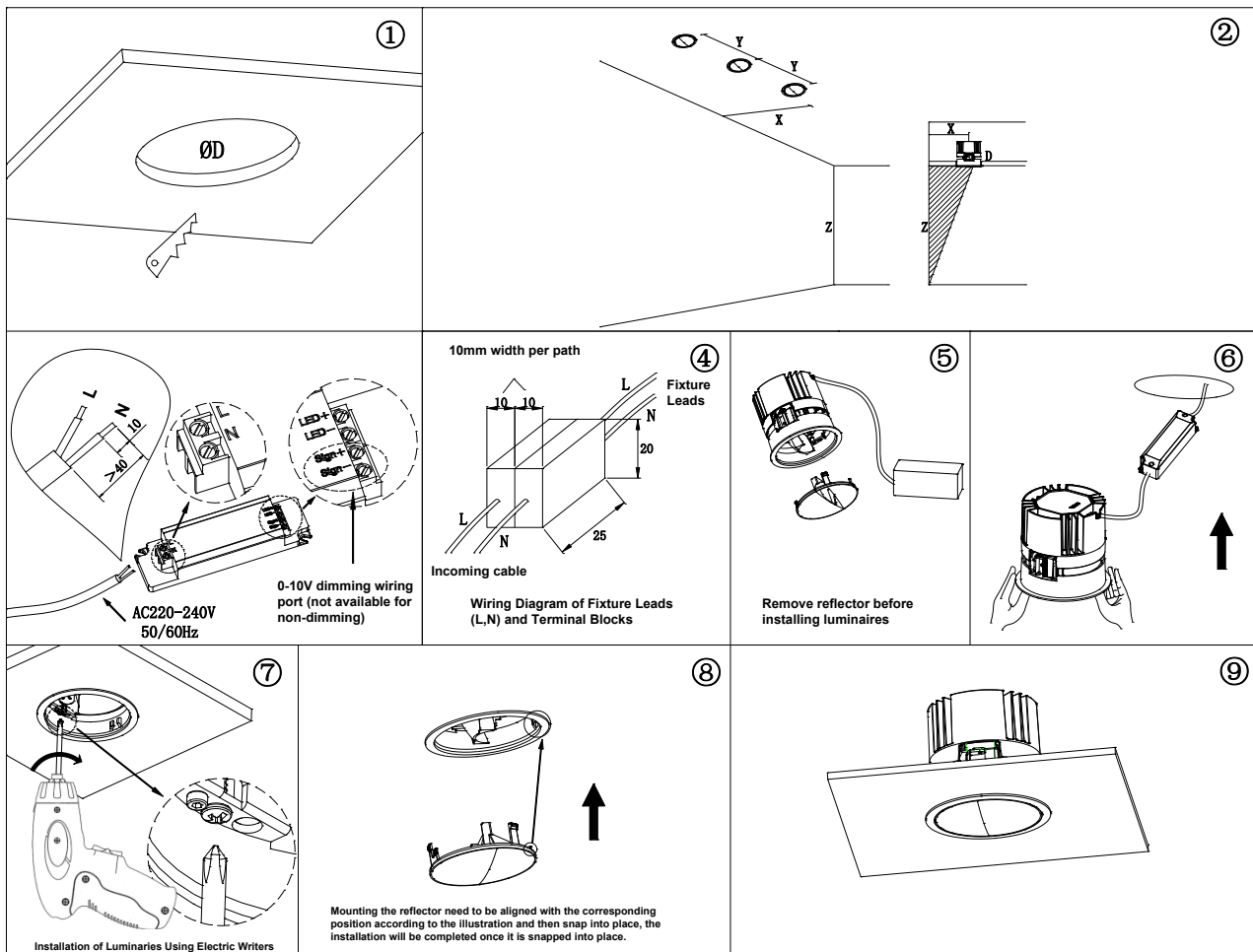

* If the electrical appliances of the luminaires come with their own leads, this connection lead needs to be connected to a separate terminal block (refer to Figure 4 for schematic wiring). The size of each terminal block should be not less than 10x20x25mm.

* Luminaire without electrical appliances (luminaire with brown and blue lead wires) cannot be directly connected to 220V AC. In which the electrical appliances provided by the customer need to match the light source.

Authorized by WAC Lighting Corporation, USA, holder of the "WAC" trademark.

China Marketing Headquarters: WAC Lighting Technology (Shanghai) Co.

Address: Room 102, No. 14, Lane 299, Bisheng Road, Pilot Free Trade Zone, Shanghai (201204), P.R.C.

China Factory: Manufactured WAC Lighting(Dongguan)Co,Ltd

Address: No. 390, Qingfeng Road, Qingxi Town, Dongguan City, Guangdong Province, 523653, P.R. China