

Installation Precautions:

1. Please read through the Instructions before installation.
2. The product should be installed by a professional electrician, make sure the power supply is cut off before installation and maintenance, to avoid the risk of electric shock.
3. Suitable for indoor installation and use (not suitable for damp environments).
4. The light can be recessed on the ceiling, where sufficient space must be reserved for installation. Do not cover the light with any thermal insulation or consumable articles to avoid fire hazards.
5. Do not install the light on an unstable or unsolid skylight, to avoid falling off.
6. The light source of this lamp is non-replaceable, and once it needs to be replaced (such as at the end of the lamp's lifespan), the entire lamp should be replaced.
7. Please keep this Instruction properly for future reference.

Light Installation and Wiring:

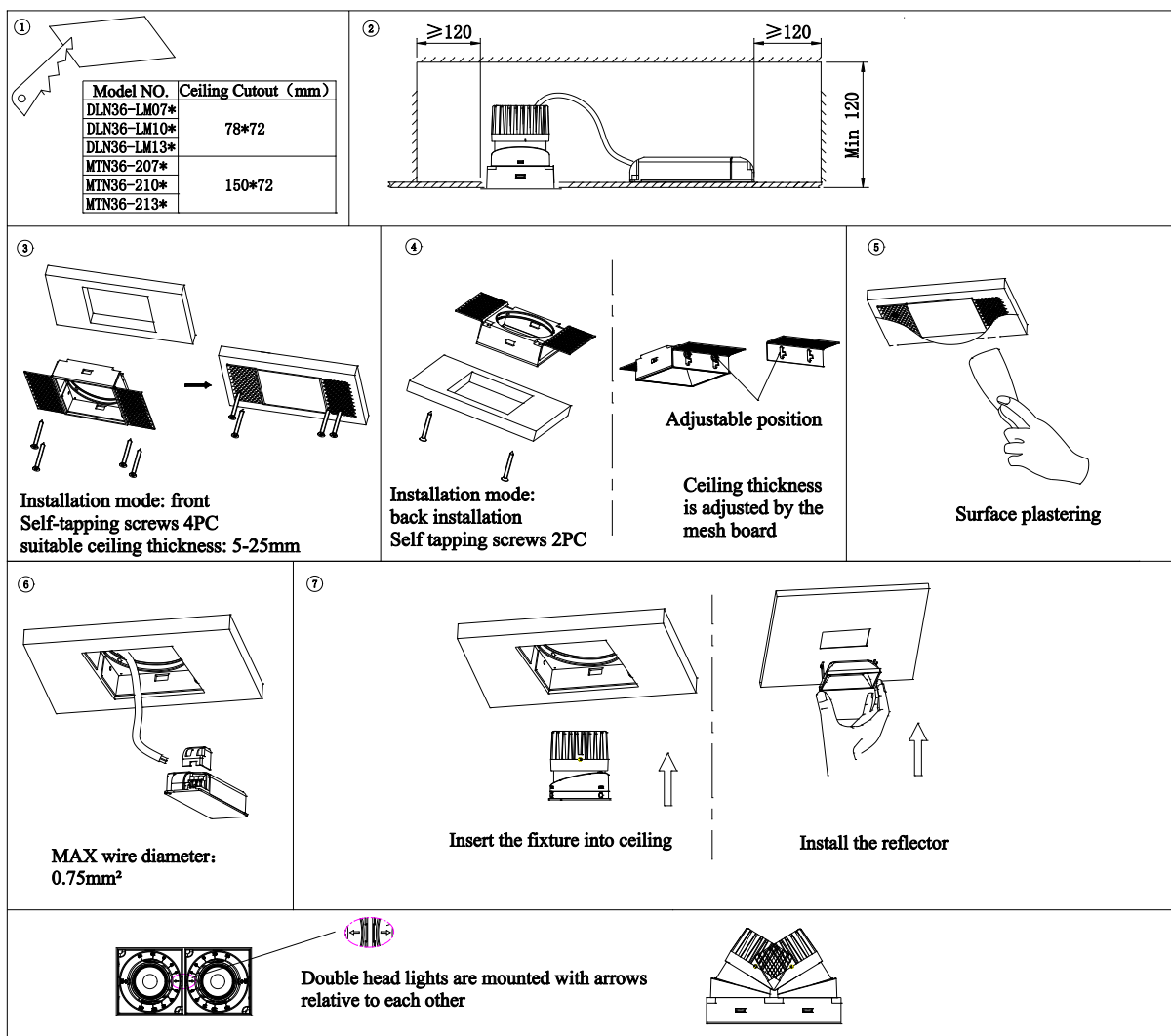

* If the driver of the light comes with lead wires, and the leads need to be connected with an independent terminal block (refer to Figure 3 for wiring), the size of the terminal block for each line should not be less than 10x20x25mm.

- * Light without driver comes with red , black , yellow and white lead wires, and it cannot be directly connected to 220V AC. Customer needs to equip the dimmer on site (DALI DT8), Electrical parameters must meet the constant current 300mA MAX, 36V Typ, Follow the instructions on the label to make the connections (the red lead wire on the light should be connected to W+, black to W-, yellow to C+, and white to C-).

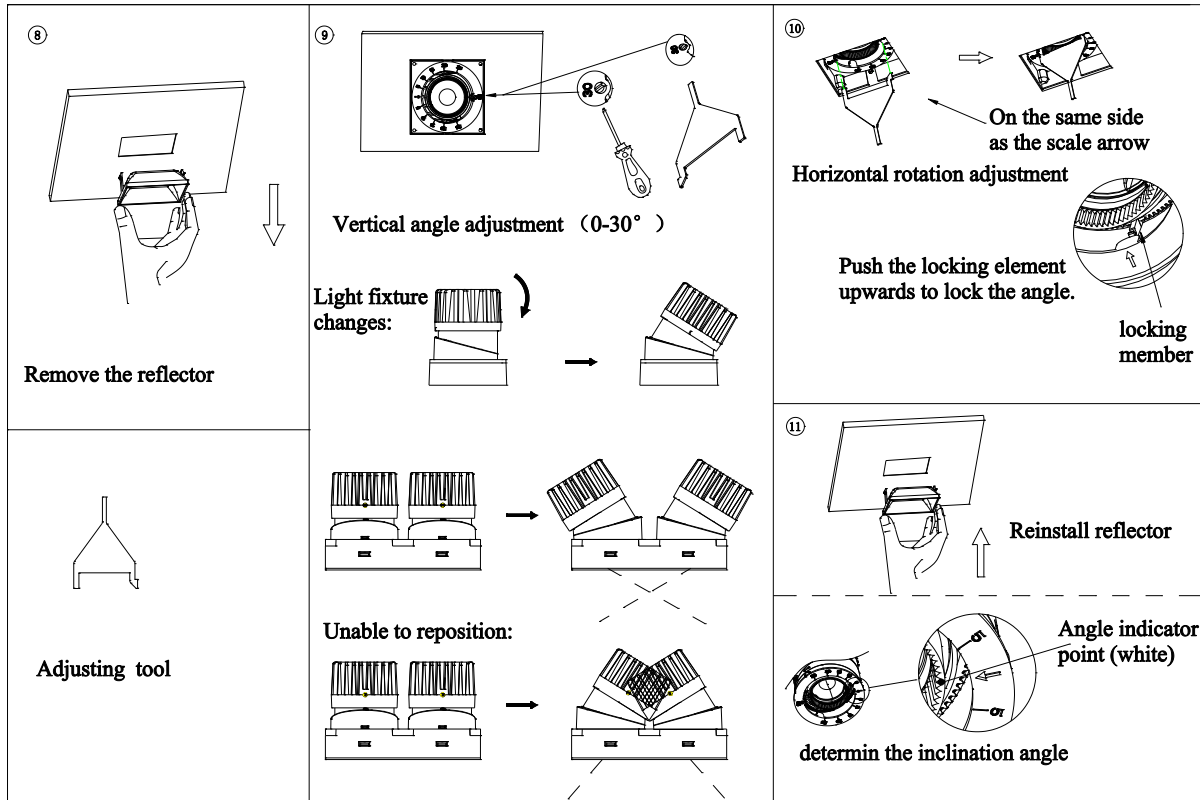

Installation Precautions:

1. Please read through the Instructions before installation.
2. The product should be installed by a professional electrician, make sure the power supply is cut off before installation and maintenance, to avoid the risk of electric shock.
3. Suitable for indoor installation and use (not suitable for damp environments).
4. The light can be recessed on the ceiling, where sufficient space must be reserved for installation. Do not cover the light with any thermal insulation or consumable articles to avoid fire hazards.
5. Do not install the light on an unstable or unsolid skylight, to avoid falling off.
6. The light source of this lamp is non-replaceable, and once it needs to be replaced (such as at the end of the lamp's lifespan), the entire lamp should be replaced.
7. Please keep this Instruction properly for future reference.

Light Installation and Wiring:

①

Model NO.	Ceiling Cutout (mm)
DLN46-LM18*	105*105
DLN46-LM25*	
MTN46-218*	205*100
MTN46-225*	

②

③

Installation mode: front
Self-tapping screws 4PC
suitable ceiling thickness: 5-25mm

④

Installation mode: back installation
Self tapping screws 2PC

⑤

Adjustable position
Ceiling thickness is adjusted by the mesh board
Surface plastering

⑥

MAX wire diameter:
0.75mm²

⑦

Insert the fixture into ceiling
Install the reflector

Double head lights are mounted with arrows relative to each other

* If the driver of the light comes with lead wires, and the leads need to be connected with an independent terminal block (refer to Figure 3 for wiring), the size of the terminal block for each line should not be less than 10x20x25mm.

* Light without driver comes with red, black, yellow and white lead wires, and it cannot be directly connected to 220V AC. Customer needs to equip the dimmer on site (DALI DT8), Electrical parameters must meet the constant current 300mA MAX, 36V Typ, Follow the instructions on the label to make the connections (the red lead wire on the light should be connected to W+, black to W-, yellow to C+, and white to C-).

