

### Installation Precautions:

1. Before installation, please carefully read the instruction manual, remove the lamp's cling film, and have a professional electrician install it;
2. To avoid the risk of electric shock, please confirm that the power is turned off before installation and maintenance. Before installing the lighting fixtures, please ensure that the installation surface is firm and reliable to prevent them from falling;
3. The light source of this lamp is non replaceable, and when the light source reaches its end of life, the entire lamp should be replaced;
4. If the external flexible cable or cord of this lamp is damaged, the cable should be replaced by the manufacturer or its service agent or a qualified person to avoid danger;
5. Keep the instruction manual for reference only.

### Installation method and steps:

The installation method of this linear lamp is ceiling mounted and requires pre fixing of U-shaped stainless steel hanging shrapnel;

The fixing holes and installation of the bracket are shown in the following figure. The length of the lamp body, the number of brackets, and the installation distance are shown in the comparison table below;

Lamp body length (mm)	Quantity of stainless steel suspension shrapnel (PCS)	Support spacing L (mm)
1010	2	500
674	2	300
338	2	200
170	2	100
86	2	50

### Installation method of stainless steel suspension shrapnel

① Drill holes according to length positioning, align the center with the notch

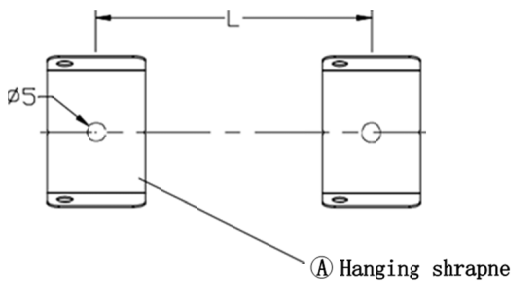

② After installing the expansion screws, use self tapping screws to lock the hanging shrapnel

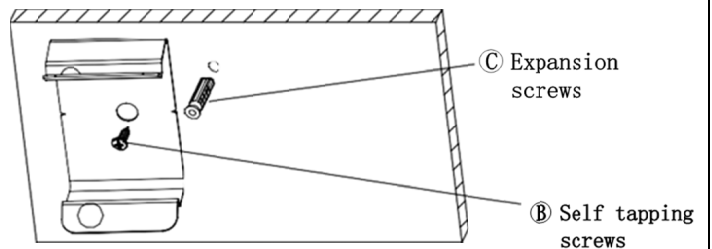

③ Hang the steel wire rope on the hanging spring, then push the lamp to the bottom and clamp it onto the hanging spring

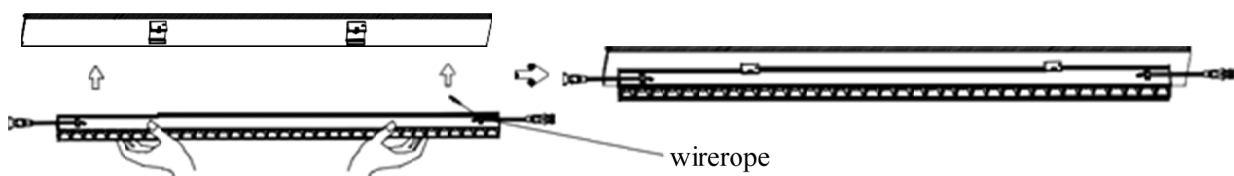

④ Connect the lighting fixtures and electrical appliances (to be provided by the electrical customer, and the lighting fixture parameters can be found on the product label) according to the identification: brown represents the positive pole, and blue represents the negative pole. Cut off the terminals on the lamp and connect the power cord with brown as the positive pole and blue as the negative pole.

**Attention:** The maximum power of a single circuit should not exceed 100W. The maximum allowable current of the male and female terminals of the power line cannot exceed 4.3A.

(For example, the high-power LGAS6-3036-303BWT model with a length of 1010mm is 30W and can connect up to 3 lamps in series. The low-power LGAS6-1836-303BWT model with a length of 1010mm is 18W and can connect up to 5 lamps in series)

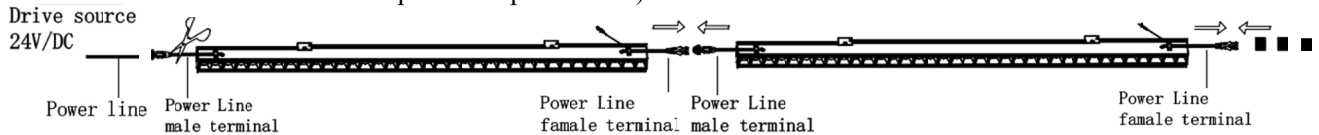

⑤ When disassembling, first hold the lamp with your hand, then use a flat screwdriver to insert it into the wing of the spring and pry it out. At the same time, pull down the lamp by hand, and the lamp body can be removed

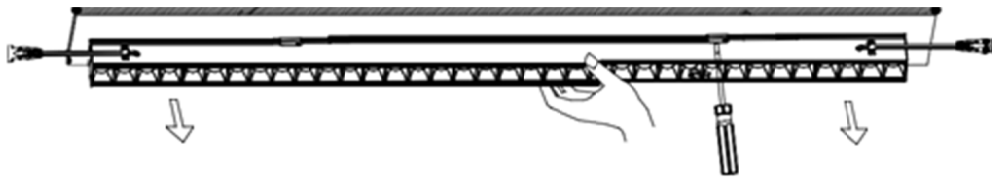

### Accessories package:

Ⓐ

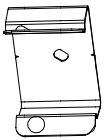

Hanging shrapnel  
quantity: 2PCS

Ⓑ



Self tapping screws  
quantity: 2PCS+1

Ⓒ

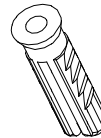

Expansion screws  
quantity: 2PCS+