

## Segment control light strip

### FLSG\* RGB monochrome white light outdoor waterproof series

#### Installation Precautions:

1. Read all instructions before installation, **and read installation precautions carefully.**
2. Although this product is a low-pressure product, do not give children play;
3. Suitable for outdoor, can do IP67;
4. Once the site is cut, the protection level is invalid. If you want to continue to use it, professional protection treatment must be done. If the end of the cut needs to be lit again, professional tools are required, please be careful;
5. The ambient temperature of the LED lamp belt is -20°C~50°C;
6. Be sure to turn off the power before installation to prevent electric shock;
7. When using the matching DC power supply, check the actual power of the lamp belt and then select a power driver with the corresponding power.
8. During the installation process, please pay attention to the wiring polarity and the working voltage requirements of the lamp belt;
9. The actual total power of the lamp can not exceed 80% of the power of the connected power supply;
10. The total length of the serial light belt is recommended not to exceed 70W, otherwise the brightness difference between the end and the end will be obvious, if necessary, please install it in parallel (as shown below);
11. In the process of use, it is necessary to ensure that there is no flammable and explosive material covered;

power	The maximum length of the string connection is recommended
12W/ m	5 m

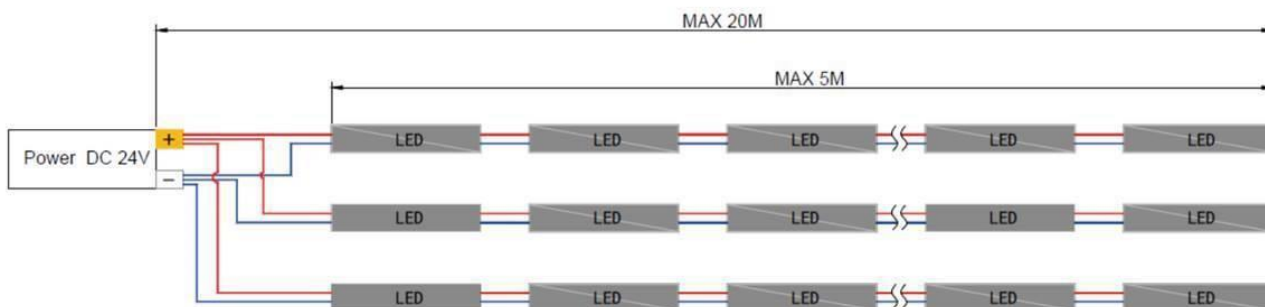

#### Outlet polarity:

This kind of product uses 24V DC power supply, the wiring method is shown in the following polarity comparison table.

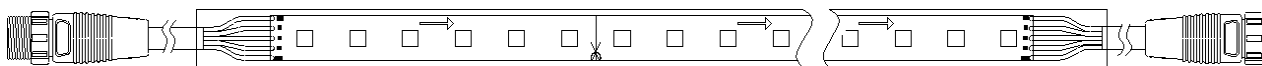

Connection table		
Colour	Feature	Effect
Brown	24V+	DC24V positive electrode
purple	B	Console signal line DMX-
orange	A	Console signal line DMX+
Black	Pin/Pout	When splicing, the Pout of the front light belt is connected to the Pin of the rear light belt, and the Pin of the signal head light position is not connected.
Blue	GND	DC24V negative electrode

## Installation mode:

### 1. Splicing mode:

When the lamp belt is splicing with the lamp belt, in order to ensure even light from the lamp, the sleeve tail is superimposed or staggered, so that the spacing of the lamp beads is the same, as shown below.

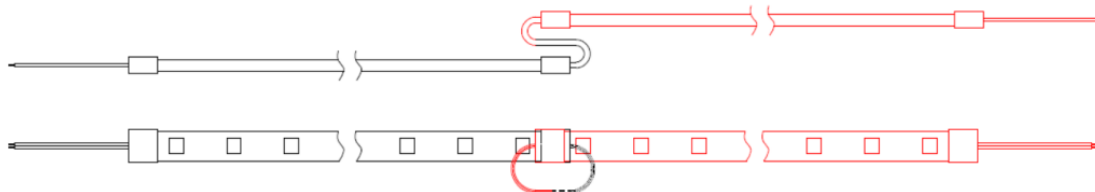

### 2. Splicing mode:

When connecting the light belt to the light belt, connect the male and female ends, but pay attention to the arrow direction on the PCB board, as follows.



### 3. Installation position

#### a. Flat surface:

Apply directly to a flat surface using lamp tape backing.

#### b. Install profiles:

The profile is installed on a flat surface, and the lamp belt is affixed to the profile using the adhesive backing of the lamp belt.

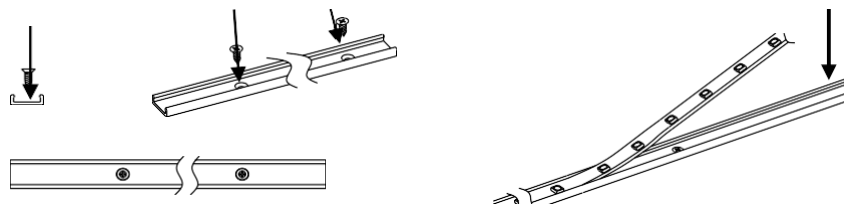

### Cropping instructions:

1. When cutting the lamp belt, please cut it at the "scissor position" of the lamp belt, otherwise the unit will not be bright. After cutting, use single component room temperature curing silicone rubber for standard protection. (as shown below)
2. After cutting the light belt, special tools are needed to renew the tail of the cut light belt. Please cut carefully.

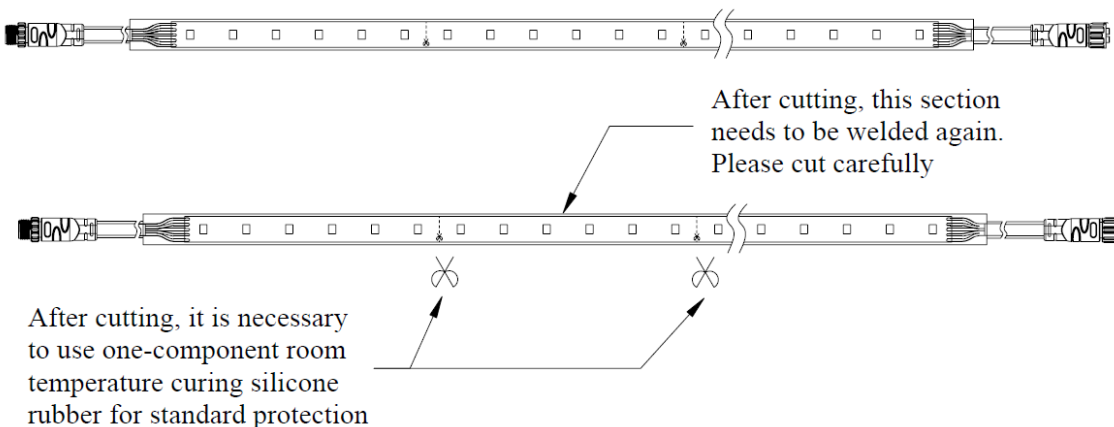

**Note:**

1. Elect the appropriate size of the track, gently press the lamp bead and the blank part of the lamp bead into the lamp belt rail, do not press or squeeze the lamp bead from the front or side;
2. During the installation, the bending radius of the lamp belt is greater than 30mm, and it cannot be strongly folded at right angles. Folding, twisting or twisting of the lamp belt is prohibited during the installation.

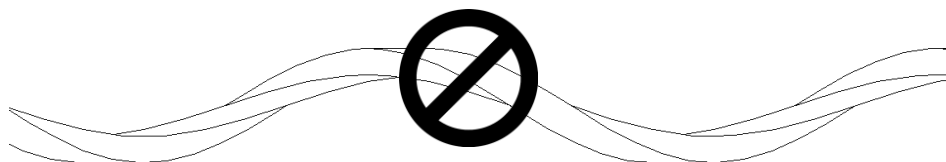

Special attention: Do not twist the lamp strip as shown